



SONOS LOW CURRENT CONSUMPTION VISUAL WARNING STROBE

A Fire and Evacuation System Compatible Device

PDS208-0060

Features:

- Low current consumption
- Simple 'twist and click' insertion
- Red, Amber and Clear options
- Quick connect/disconnect
- IP65 weather proof options (deep base units) for indoor and outdoor use



208-0060 Shown

Description

The SONOS low current Visual Warning strobes are general purpose LED strobes for fire, security and industrial applications.

The strobes come with the flexibility of individual Red, Amber and Clear strobes or combined Red/Amber strobe units complete with either a flush or surface mounting plate. The strobes utilise a full faced, translucent case which provides a much larger lens area and a greater spread of light.

The strobes are suitable for use with AMPAC's EV3000 system (both single and combined) and AMPAC's fire panels (Single only).

Simple 'twist and click' insertion avoids wiring and connection problems.



Figure 2: 208-0063 Combined Strobe (Flush Mount)

Applications

- | | |
|--------------|-------------------|
| ➤ Fire | ➤ Railway/Marine |
| ➤ Security | ➤ Hazardous Areas |
| ➤ Industrial | ➤ Public Warning |

Mechanical Details

The combined strobes only require 2 wires to switch between red and amber strobes.

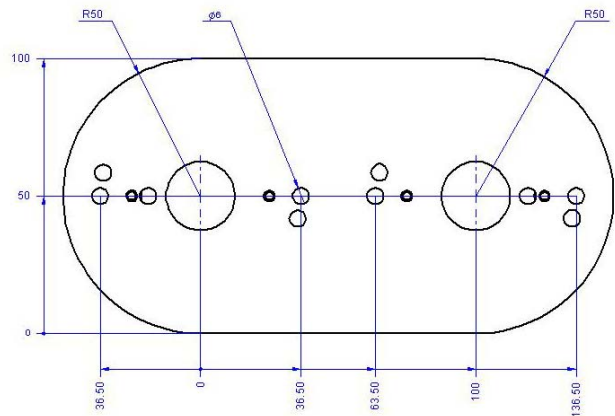

Figure 3: 208-0063 Flush Mounting Plate Dimensions

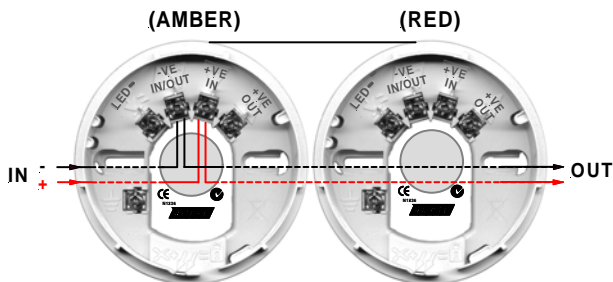

Figure 1: 208-0063 Combined Strobe Wiring



SONOS LOW CURRENT CONSUMPTION VISUAL WARNING STROBE A Fire and Evacuation System Compatible Device

PDS208-0060



Figure 4 208-0066 Combined Surface mount

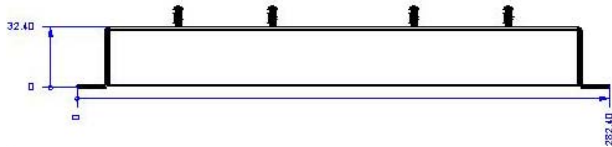
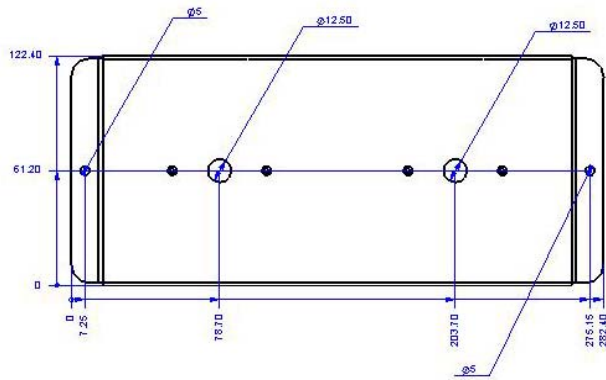

Figure 5: 208-0066 Surface Mounting Plate Dimensions



Figure 6: 208-0062 C/W IP65 Deep Base

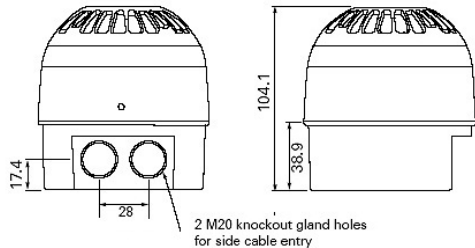

Figure 7: 208-0064 IP65 Deep Base Dimensions

Specifications

Operating voltage	17 – 60 Vd.c.
Current drain	5mA
Flash Frequency	400-2850Hz
Operating Temp	-25° to +70°C
Material – Base Lens	High Impact Polycarbonate Flame Retardant Polycarbonate
IP Rating Shallow IP Rating Deep	IP21 IP65
Colour Base Colour Lens	White Red, Amber, Clear
Dimensions (mm)	
Strobe Shallow Base	60 (H) x 90 (Dia) 24 (H) x 90 (Dia)
Mounting Plate	200 (L) x 100 (W) (flush) 282 (L) x 122 (W) x 33(D) (surface)
Weight Shallow Base Deep Base	215g 250g
Approvals	C-tick

Item Numbers

Red	208-0060
Amber	208-0061
Clear	208-0062
Red / Amber Combined (Flush)	208-0063
Red / Amber Combined (IP65)	208-0065
Red / Amber Combined (Surface)	208-0066
Deep Base (IP65)	208-0064
Orbis Timesaver Base	201-0545
Visual Brd Kit (LED) (EV3000 only)	4210-0031
Strobe Sign Plate "FIRE"	207-0042