

ADVANCED WARNING

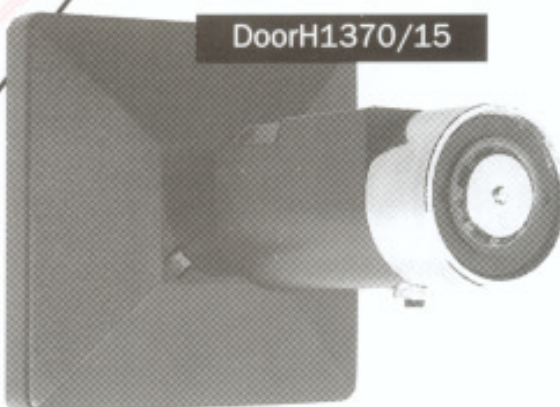

TWO HOLDING
FORCE SETTINGS

CONVERTIBLE FLOOR/CEILING
OR WALL MOUNT

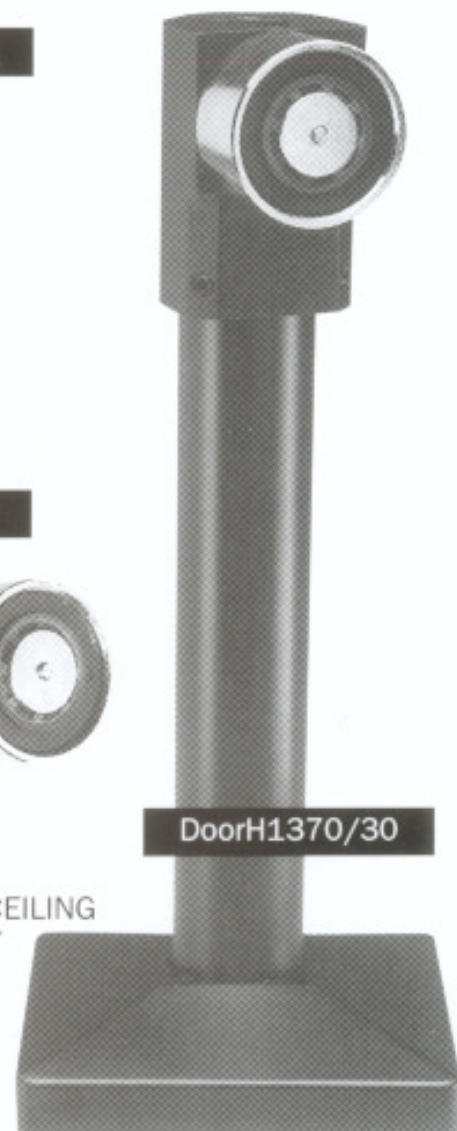

ELECTRO - MAGNETIC DOOR HOLDERS

Ampac offer a comprehensive range of Electro-Magnetic door holders which are low cost, extremely reliable, robust and aesthetically pleasing. This quality product is designed for maximum flexibility during installation eg. The same door holder is floor/ceiling or wall mount ; surface mount door holders have a choice of two holding force settings. This cost effective product range will help save you time and money on site.



Our aim is to provide 'Consistently Excellent Service' in the eyes of our customers

ELECTRO-MAGNETIC DOOR HOLDERS

MODEL NO

Description

HOUSING COLOUR
POWER SUPPLY AND CURRENT CONNECTIONS
HOLDING FORCE
PIECE PER PACKAGE
WEIGHT OF UNIT

ACCESSORIES SPARE PARTS AND OTHER MODELS

- ON EQUIPMENT
- ★ ON REQUEST

D00RH1330

Electro-magnetic door holder

Electro-magnet designed to hold fire/smoke check doors open for convenience and release them automatically in the event of fire. Supplied with keeper plate.

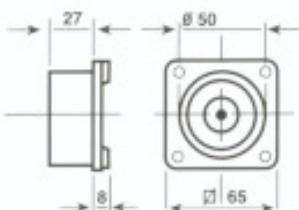

Thermoplastic base

Black
24Vdc - 60mA - 1.4W
Two - 0.35 x 20cm. wires
~ 50kg
1
420 gr.

- ★ ~ 100Kg Holding force

D00RH1350

Electro-magnetic door holder

Like 1330 but with facility to halve the holding force. Connections are on the printed circuit inside the housing. Release button can be placed on either side. Supplied with keeper plate.

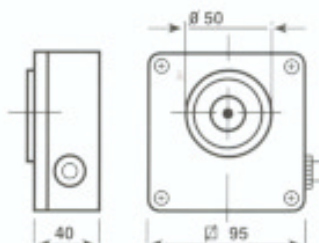

Aluminium die-cast and thermoplastic

Housing white - cover black
24Vdc - 60mA - 1.4 W
Screw terminals
~ 25/50 Kg
1
700 gr.

- Adhesive fixing template for electro-magnet.
- Wall plugs and fixing screws.
- ★ ~ 100 Kg Holding Force

D00RH1365

Magnetic door holder

Permanent magnet to hold open the doors and release them automatically when electro-magnet receives a voltage pulse.

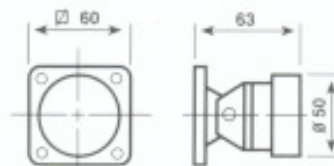

Aluminium die-cast and thermoplastic

Black
24Vdc - 250mA - 6W
Two - 0.35 x 20cm. wires
~ 25 Kg
1
900 gr.

MODEL NO

Description

HOUSING COLOUR
POWER SUPPLY AND CURRENT CONNECTIONS
HOLDING FORCE
PIECE PER PACKAGE
WEIGHT OF UNIT

ACCESSORIES SPARE PARTS AND OTHER MODELS

- ON EQUIPMENT
- ★ ON REQUEST

D00RH1368

Flush mounting electro-magnetic door holder

Flush mounting version of 1330. Front cover in anodized aluminium. Supplied with keeper plate.

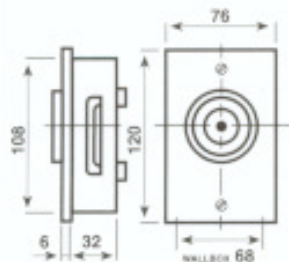

Galvanized steel box

Natural aluminium
24Vdc - 60mA - 1.4W
Two - 0.35 x 20cm. wires
~ 50 Kg
1
650 gr.

D00RH1370/15 - 1370/30

Electro-magnetic door holder with bracket.

The use of the bracket enables the installation on floors, ceilings and walls. The total height of 15 cm (MOD. 1370/15) or 30 cm (MOD. 1370/30) can be adjusted By 3 cm. Supplied with release button and keeper plate.

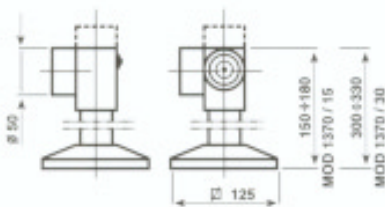

Steel bracket: electro-magnetic support in aluminium

Black
24Vdc - 60mA - 1.4W
Two - 0.35 x 20cm. wires
~ 50 Kg
1
1,200 - 1,550 gr.

- Base cover
- ★ ~ 100Kg Holding Force

D00RH1351

Keeper Plate

The Keeper comprises of a heavy duty thermoplastic mounting base with a spring loaded nickel plated keeper plate. The keeper plate is able to rotate by 60° from its central axis.

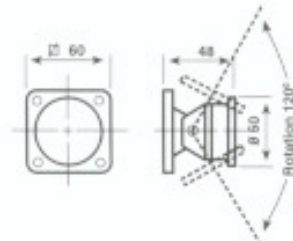

Features

- All electro magnetic door holders are fitted with a residual magnetism release pin, for quick release
- Durable powder coat finish
- Elegant design
- Easy to install
- Very reliable and robust
- Low cost



www.ampac.net

AUSTRALIA

97 Walters Drive
Osborne Park 6017
Western Australia
Tel: 61-8-9242 3333
Fax: 61-8-9242 3334
email: info@ampac.net

EUROPE

Ampac Europe Ltd
Unit 1 Norden Court, Alan Ramsbottom Way
Great Harwood, Blackburn, England BB6 7UR
Tel: 44 (0) 1254 880 201
Fax: 44 (0) 1254 880 202
email: info.eu@ampac.net

NEW ZEALAND

Ampac Industries Ltd
Unit D/33 Porana Road, Gient
Auckland New Zealand
Tel: 64-9-443 8072
Fax: 64-9-443 8073
email: info.nz@ampac.net